

DYNATECTTM
DYNAMIC EQUIPMENT PROTECTION

GORTITE[®] ALUMINUM ROLL-UP DOORS

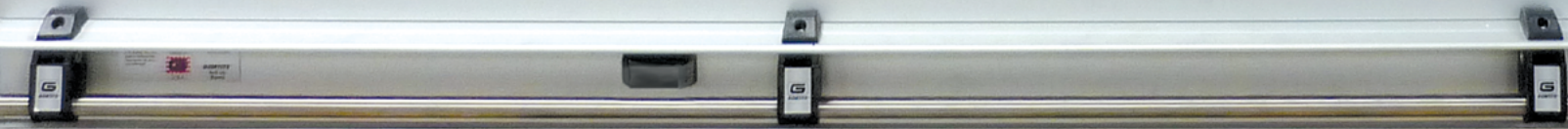

OPTIMIZED FOR DELIVERY VEHICLES



Global Leaders in Dynamic Protection for Equipment and People

FEATURES & BENEFITS

GORTITE® ROLL-UP DOORS

INSTALLATION BENEFITS

- **EASY INSTALLATION** – Dynatect has revolutionized the installation of roll up doors that reduces installation time, labor, and cost. Dynatect now offers a bolt-in installation designs that include the rails, slatted doors, and just four vehicle connection points. This design can support under one-minute installation in high-volume OEM environments and allows for field/depot replacement with minimal time/tools required.
- **PERFECT FIT** – Dynatect can be the single source for fit / form / function. Dynatect offers customizations including curved rails and roller positions that provide contoured fit with existing designs. Dynatect also provides the doors as individual parts or as an assembled drop-in assembly (door and frame pre-assembled). Additional Dynatect options include a custom beauty-cover to close exterior gaps, and fascia caps to cover external mounting locations.
- **EASY RETROFIT** – Dynatect has standard and custom offerings, including options to replace swing-out doors with prepackaged roll-up door assemblies.



EASY, BOLT-IN
INSTALLATION AND
RETROFIT SOLUTIONS
FOR SWING-OUT DOORS.



*FASCIA CAPS /
BEAUTY COVER

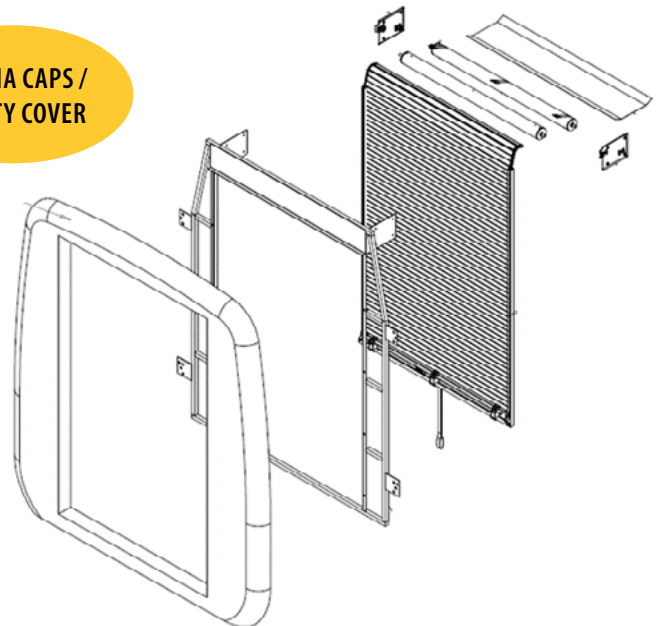

*This is an example of how we can work with customers for a line or fleet of vehicles (higher volumes)

PREMIUM APPEARANCE & BRAND APPEAL

- **BRAND ENHANCEMENT** – Dynatect’s doors feature a smooth, satin anodized aluminum finish. Automotive-grade paint finish also available. Either finish complies with automotive grade UV stability and supports the addition of brand/logos with excellent decal adhesion



PREMIUM, SATIN-ANODIZED ALUMINUM OR AUTOMOTIVE-GRADE PAINT FINISH. PAINT FINISH ALSO INCLUDES A PROTECTIVE, GLOSS CLEAR COAT.



STORAGE & CARGO BENEFITS

- **PROTECT YOUR CARGO** – Dynatect RUD features slats with double-sided aluminum extrusions which are tamper resistant. The ideal balance of minimizing weight, while maximizing durability and security. Door locks are standard for delivery vehicles, power door locks are optional.
- **REDUCE CARGO DAMAGE** – Traditional “garage doors” with rails that run the length of the ceiling bring the snow and rain directly into the cargo area to drip onto cargo and operators. In contrast, Dynatect’s water management features include bottom door seals and a roller canister that captures the entire door in a confined area (drip pan also available).
- **MAXIMIZE CARGO SPACE** – Dynatect’s small slat height allows the door to be fully contained in a small rolled up space, consuming minimal overhead while maximizing opening height, operator room and cargo space. Traditional “garage doors”, with rails that run the length of the ceiling, create interference for operators and tall cargo.

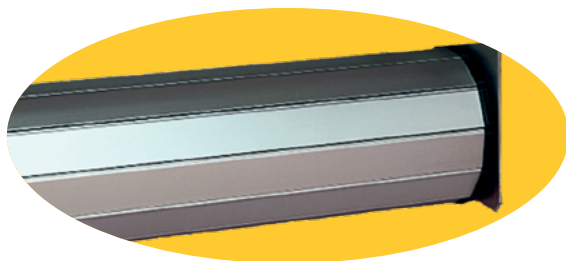

Dynatect’s Gortite spring-loaded take-up rollers are only 3 inches in diameter and allow for a compact roll-up diameter resulting in maximum compartment storage and maximum head room for vehicle entry/egress.

PRODUCTIVITY BENEFITS

- **OPTIMIZE ACCESS LOCATIONS** – Dynatect supports both rear roll up doors and side roll up doors that speed loading and unloading. Confidently create the access where it is needed.

- **ACCOMMODATE LOADING DOCKS** – For delivery vehicles that may have mixed destinations, including loading docks, traditional swing-out doors create challenges. The driver must back up near a dock, then open the swing-out doors, then back up to the dock (without damaging the doors) – and all the same steps before leaving.



In contrast, roll up doors eliminate multiple stops/starts and the vehicle can be backed up once to the dock with full usability to open and close the door. Additionally, any incidental impact from backing up is absorbed by the bumper rather than a swing-out door.

- **AUTOMATION AVAILABLE** – Dynatect offers motorized roll up doors with remote controls to reduce operator repetitive motions and speed each delivery with advanced open and post close while the operator is executing deliveries. Traditional swing out-doors cannot be easily automated would require multiple actuators to open both doors.

FEATURES & BENEFITS

GORTITE® ROLL-UP DOORS

SAFETY BENEFITS

Roll up doors minimize the footprint of the vehicle and keep the operator closer, reducing damage, injuries, and workers' compensation costs. Here's how:

- **PINCH POINT SAFETY** – Dynatect's roll up doors feature slats that are 1-3/8" tall and closely coupled together which eliminates the pinch points of a traditional paneled roll up door. Roll up doors also eliminate the hinged pinch points of swing-out doors.
- **IMPACT SAFETY** – Swing-out doors create impact hazards in the presence of traffic, bicycles, pedestrians, street signs and trees. They create the additional challenge of forcing operators to walk around the door in the presence of these hazards.
- **REDUCE OPERATOR STRAIN** – Help reduce risk of injury and fatigue with convenient access doors that roll open. Dynatect's spring roller technology includes calibrated tension that ergonomically balance the door for least effort opening and closing force. Each door also features a pull strap to accommodate closing while the operator is standing on the ground, regardless of truck height.
- **IMPROVE SAFETY ON SLOPES** – Traditional "swing-out doors" can fight the operator when vehicle is parked on steep slopes. Under these conditions, gravity makes the doors less controllable when opening, or not staying open, depending on which direction of the vehicle is parked. In contrast, Dynatect's roll up door changes the direction of door motion and is spring tensioned to provide consistent performance regardless of how vehicle is parked on a slope. The roll up door will not accidentally move in response to parking on steeply sloped streets.



Pull Strap
Ideal for tall doors

VEHICLE BENEFITS

- **LIGHTWEIGHT MATERIALS** – Dynatect’s aluminum slats are formed hollow core, with the industry’s thinnest walls resulting in the lowest weight-to-rigidity ratio. This reduced weight has the added benefit of providing more fuel efficiency and more reliable EV range.
- **REDUCE CARGO LIGHTING DEMAND** – Many delivery vehicles include translucent ceilings in the cargo area to minimize the need for electric lighting. When these vehicles are combined with traditional “garage doors” that run the length of the ceiling, electric lights are needed to compensate for the obscured sunlight. Dynatect’s compact door roller eliminates overhead interference, maximizing sunlight, minimizing the need for supplemental light. This reduced electrical usage has the added benefit of providing more reliable EV range.
- **DURABILITY** – Life cycle tested to 250k open/close cycles with 20 years of field-proven weather resistance. Design eliminates metal-on-metal contact which reduces premature wear and supports longevity. Bulb seals are made of EPDM, which has high resistance to UV’s and adjusts to both extreme cold and hot temperatures.



Lightweight, Corrosion-Resistant Anodized Aluminum Slats
Rugged, double-walled slat construction with weather sealing between each slat.

**RIB DESIGN
MINIMIZES CARGO
HANG-UPS**

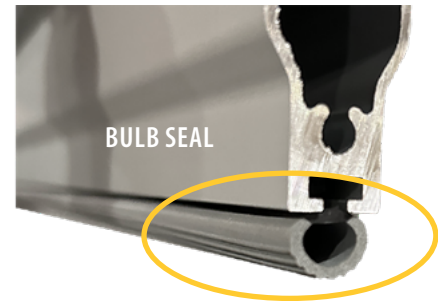

BULB SEAL

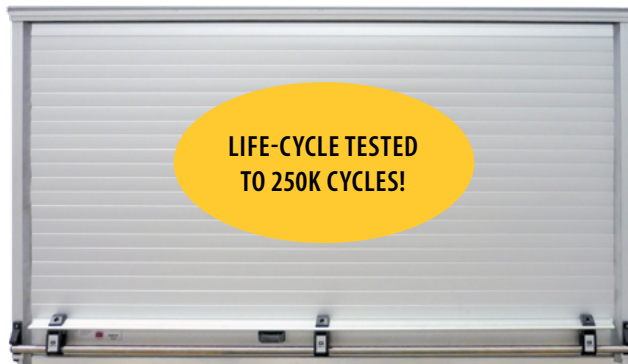

**LIFE-CYCLE TESTED
TO 250K CYCLES!**



LED Cabinet Lighting

Bright, long-lasting and energy efficient lighting at 30 lumens per LED. Wide 180° dispersion angle. Water and salt resistant. Meets NFPA 1901 standard.

FEATURES & BENEFITS

GORTITE® ROLL-UP DOORS

PARTNER SELECTION

- **PROVEN PARTNER** – Dynatect has been providing roll up doors for utility vehicles for over 10 years, building on an even stronger foundation.
 - Dynatect is the US market leader in roll-up doors for emergency vehicles – with 20 years of vehicle door experience and 100,000 installations.
 - Dynatect doors are designed, manufactured, and supported in North America with the ability to serve from 4 U.S. manufacturing locations.
 - Dynatect has a 75-year history of making robust industrial, construction, and fire/emergency solutions.
 - For over 25 years, Dynatect has deployed lean principles to maximize product performance while managing costs.
- **LATEST TECHNOLOGY** – Dynatect is always offering customers leading edge technology. Dynatect invests in new product development including power locks, custom handles, motorized doors, remote controls, materials technology, and water-mitigation.
- **NATIONWIDE SUPPORT** – Largest technical sales network
- **LIFETIME WARRANTY** – For the spring-loaded take-up roller



See-Through Slats

Transparent, rugged polycarbonate material



Inside Opening Lift Bar

Option for opening / closing from cargo side of door



Rugged Lift Bar

Easy grip stainless steel lift bars withstand force and speed for opening the door

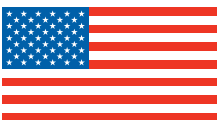

DESIGNED & MANUFACTURED IN THE USA

STANDARD COMPONENTS

GORTITE® ROLL-UP DOORS

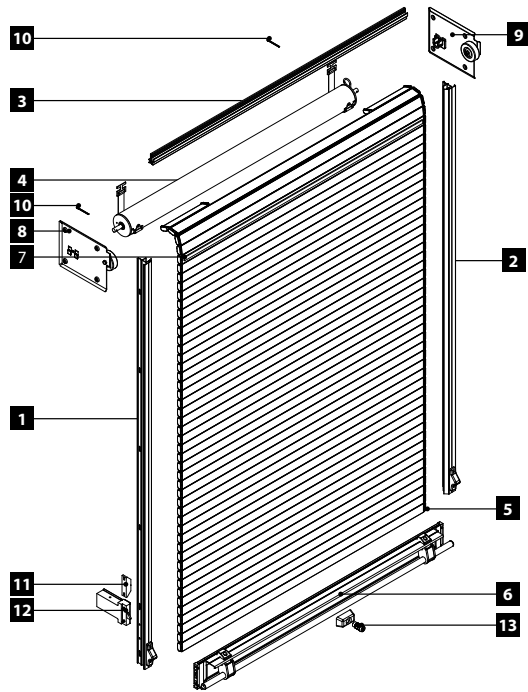

DESCRIPTION	QTY.
1 Side Rail, Left	1
2 Side Rail, Right	1
3 Top Rail	1
4 Roller	1
5 Shade	1
6 Handle Assembly	1
7 Door Seal Foam	1
8 Pennant Plate, Left	1
9 Pennant Plate, Right	1
10 Roller Pin	2
11 Door Ajar Switch	1
12 Power Door Lock	1
13 Manual Lock	1



Top Drip Rail (option)



Sill Plates (option)

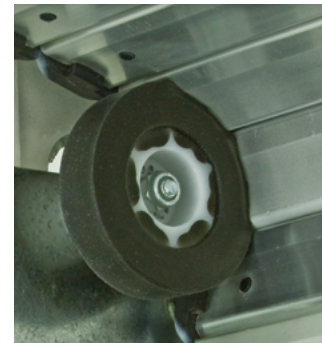

Idler Wheel / Idler Roller

Elastomer-covered surface dampens noise and vibration

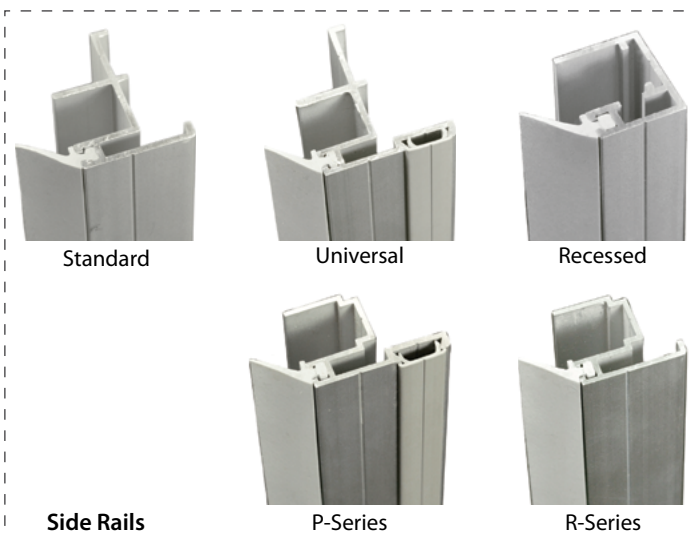

Standard

Universal

Recessed

Side Rails

P-Series

R-Series

HOW TO SPECIFY

SO, HOW DO I SPECIFY GORTITE® ROLL-UP DOORS? IT'S EASY!

- Roll-up doors shall be Gortite brand manufactured by Dynatect Manufacturing, Inc.
- Roll-up doors to be constructed of double-sided aluminum extrusions. The extrusions are to be 1-3/8" tall and 3/8" thick with satin anodized finish or painted to match truck body.
- A flexible extrusion shall be installed between each slat to ensure a weather-tight seal
- Aluminum extrusions shall be individually replaceable without disassembling the entire door by removing push out clips on each end
- Side channels for the door to ride in shall be provided with seals to prevent dirt and moisture from entering compartment. A single piece top drip rail shall be provided with a seal to prevent dirt and moisture from entering the compartment when the door is fully closed. Bottom of door will also be provided with a seal.
- All non-metallic parts to be glass-filled nylon
- Lift bar shall be made of stainless steel

- The door shall be capable of operating in temperatures of -40° F to 180° F
- Optional accessories shall include a magnetic door ajar system, compartment lighting, manual key lock, power lock, sill plate and pull strap for tall doors
- Vendor shall have at minimum twenty (20) years of installed and operating roll up door assemblies in field applications

OUR LIFETIME ROLL-UP DOOR WARRANTY

The roll-up doors have the following warranties to be free from defects in materials and workmanship:

- Lifetime for the spring-loaded roller
- 3 years for all other parts
- 5 years for optional painted finish (free from peeling or blistering)
- 1 year for optional electronic equipment
- Warranties are from date of shipment and apply to the original owner
- Damage due to accidents or external causes are not warranted

NEED A DOOR SOLUTION WITH CUSTOM FEATURES?

We offer full engineering and design support to integrate into your vehicle with custom features, options and accessories.

DYNATECT IS AN ESTABLISHED HIGH-VOLUME TIER 1 AUTOMOTIVE SUPPLIER.

DYNATECT AUTOMOTIVE EXPERIENCE/FEATURES INCLUDE:

- Curved door frames and doors that follow the interior vehicle contour
- Frame mountings that facilitate retrofit to swing-out door mounting points
- Composite beauty covers
- Automotive water management compliance
- Automotive brake/squeak/rattle (BSR) compliance
- Optimized ergonomics to minimize repetitive motions and operator strain
- Customizable locks and power-lock options (including signal duration and power draw)
- Customizable latching options
- Motorized door options with key-fob control integrated into BCM

FIND A LOCAL DYNATECT REP:

[Visit Dynatect.com/Find-Rep](https://www.dynatect.com/Find-Rep)

CONNECT

GLOBAL HEADQUARTERS
2300 South Calhoun Road
New Berlin, WI 53151

phone: +1 262 786-1500
fax: +1 262 786-3280
email: sales@dynatect.com

DYNATECT.COM